



SUMMERLEY STREET, SW18 4EX

Offers Over £425,000

We are pleased to offer a light, airy and extended two bedroom ground floor flat situated on this popular road close to Earlsfield Station. This lovely property benefits from a bright open plan kitchen/reception room, bathroom, a double bedroom and a single bedroom/nursery/study room. The flat also has direct access to a private garden area, a communal garden and also a private front garden. Summerley Street is a quiet residential road located moments away from Garratt Lane and all of its shops, restaurants and local amenities. Also on the doorstep is Earlsfield Mainline Station as well as the River Wandle and Garratt Park. Leasehold. EPC rating C. Wandsworth Council Tax Band C. Please see the virtual tour provided: <https://my.matterport.com/show/?m=LsTztvYiWwg>.



www.maalems.co.uk

Earlsfield & Wandsworth Office
344 Garratt Lane
Earlsfield, London SW18 4EL
T: 020 8875 9200
earlsfield@maalems.co.uk

Registered in England & Wales No. 5585458



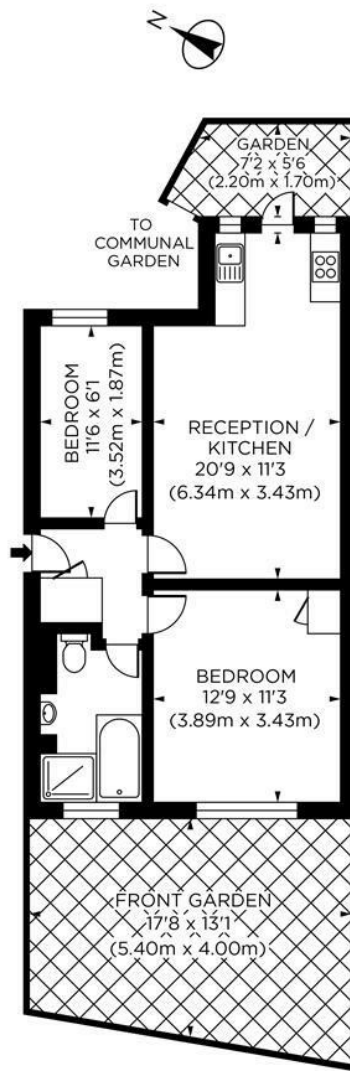

GROUND FLOOR

Summerley Street, SW18
Gross Internal Area 560 sq ft/52 sq metres
©photosandfloorplans.com

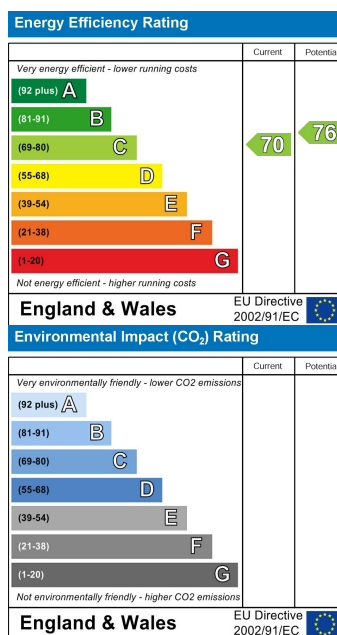
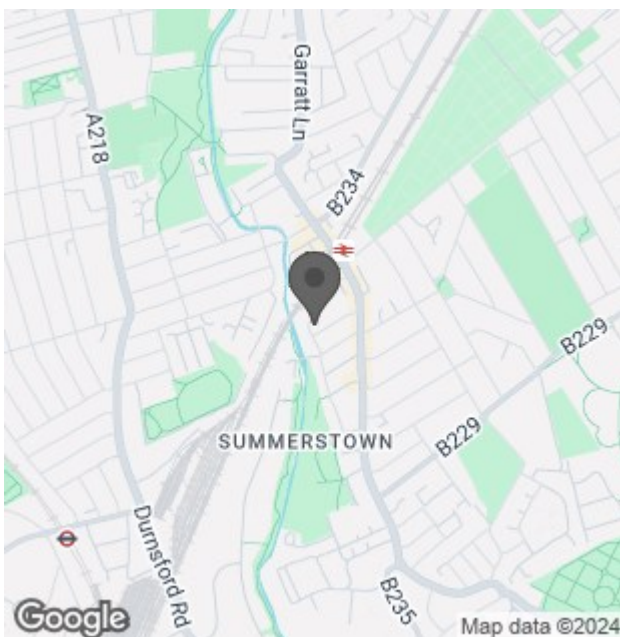

For an instant or face to face valuation, please scan the QR code:



www.maalems.co.uk
Earlsfield & Wandsworth Office
344 Garratt Lane
Earlsfield, London SW18 4EL
T: 020 8875 9200
earlsfield@maalems.co.uk

Registered in England & Wales No. 5585458

